

# St. James Road, SE1

Approximate Gross Internal Area

Ground Floor = 41.9 sq m / 451 sq ft

First Floor = 43.3 sq m / 466 sq ft

Garage = 12.7 sq m / 137 sq ft

Total = 97.9 sq m / 1054 sq ft

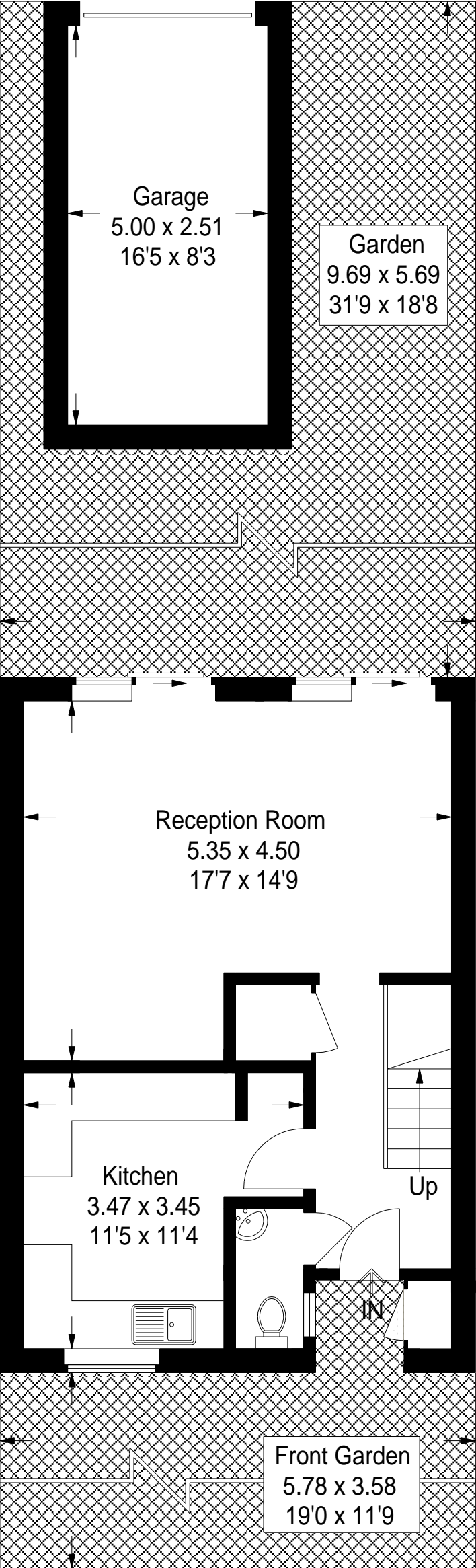

Ground Floor

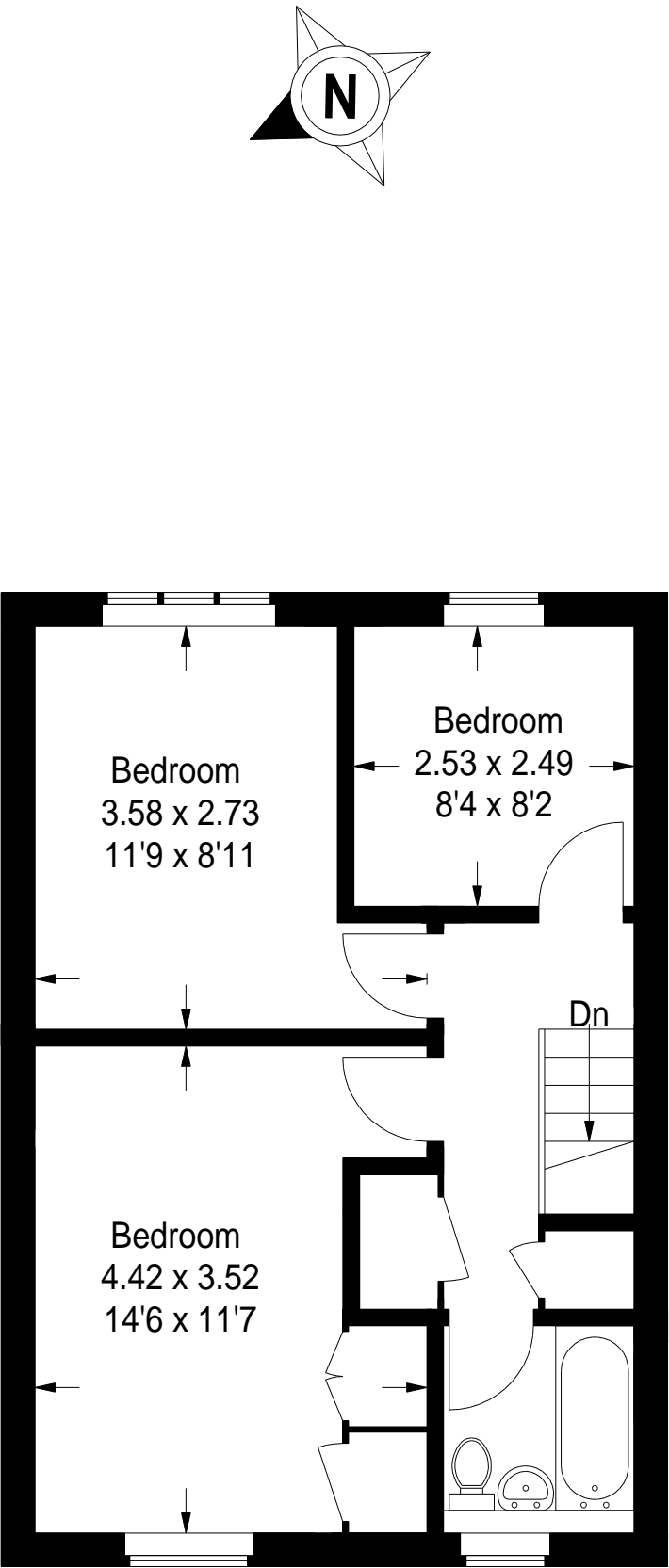

First Floor

This plan is for layout guidance only. Not drawn to scale unless stated.  
Windows and door openings are approximate. Whilst every care is taken  
in the preparation of this plan, please check all dimensions, shapes and  
compass bearings before making any decisions reliant upon them. (ID912286)