

**£395,000.00 Asking Price Of  
Metro Central Heights, Southwark, London SE1 6DQ**



**PROPERTY OVERVIEW**

**2 Bedrooms   1 Bathroom   1 Reception**

This bright and spacious two-bedroom apartment is situated in the prestigious Metro Central Heights development, ideally located in the heart of Elephant and Castle. Perfect for end users or investors, the property offers a harmonious blend of convenience and practicality.

Upon entering, you are greeted by a welcoming hallway complete with two built-in storage cupboards, ensuring a clutter-free living space. The property features two well-sized double bedrooms, the main bedroom thoughtfully designed with built-in storage, providing ample room for personal belongings. The modern open-plan kitchen and living area boast contemporary appliances and a functional layout ideal for entertaining or relaxing. Large windows throughout the apartment flood the space with natural light, creating a w ...

35a St Georges Road,  
London SE1 6EW

+44 (0) 207 401 2020

[www.globalhouseestates.com](http://www.globalhouseestates.com)

Level 24, Lee Garden One,  
33 Hysan Ave, Causeway  
Bay, Hong Kong

+852 3963 8411

**SALES | LETTINGS | PROPERTY MANAGEMENT | PROPERTY INVESTMENTS**



35a St Georges Road,  
London SE1 6EW  
+44 (0) 207 401 2020

[www.globalhouseestates.com](http://www.globalhouseestates.com)

Level 24, Lee Garden One,  
33 Hysan Ave, Causeway  
Bay, Hong Kong  
+852 3963 8411

SALES | LETTINGS | PROPERTY MANAGEMENT | PROPERTY INVESTMENTS



35a St Georges Road,  
London SE1 6EW  
+44 (0) 207 401 2020

[www.globalhouseestates.com](http://www.globalhouseestates.com)

Level 24, Lee Garden One,  
33 Hysan Ave, Causeway  
Bay, Hong Kong  
+852 3963 8411

SALES | LETTINGS | PROPERTY MANAGEMENT | PROPERTY INVESTMENTS



GLOBAL  
HOUSE  
ESTATES



35a St Georges Road,  
London SE1 6EW  
+44 (0) 207 401 2020

[www.globalhouseestates.com](http://www.globalhouseestates.com)

Level 24, Lee Garden One,  
33 Hysan Ave, Causeway  
Bay, Hong Kong  
+852 3963 8411

SALES | LETTINGS | PROPERTY MANAGEMENT | PROPERTY INVESTMENTS



GLOBAL  
HOUSE  
ESTATES

## Newington Causeway, SE1 6DQ

Approx Gross Internal Area = 54.7 sq m / 589 sq ft

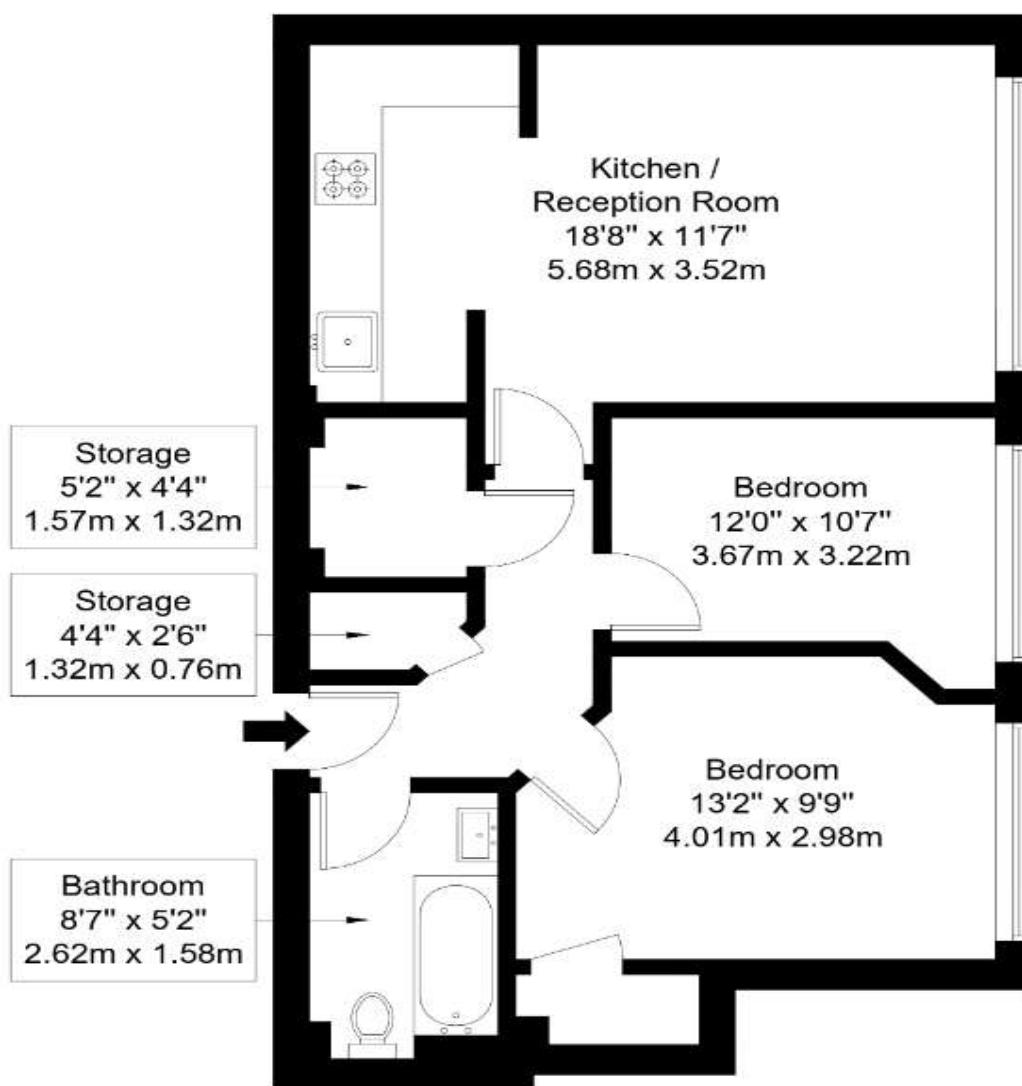
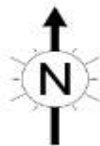

First Floor

Ref :

Copyright **BLEU  
PLAN**

The Floor plan is not to scale and measurements and areas shown are approximate and therefore should be used for illustrative purposes only. The plan has been prepared in accordance with the RICS code of Measuring Practice and whilst we have confidence in the information produced it must not be relied on. Maximum lengths and widths are represented on the floor plan. If there is any aspect of particular importance, you should carry out or commission your own inspection of the property.  
Copyright © BleuPlan

35a St Georges Road,  
London SE1 6EW

+44 (0) 207 401 2020

[www.globalhouseestates.com](http://www.globalhouseestates.com)

Level 24, Lee Garden One,  
33 Hysan Ave, Causeway  
Bay, Hong Kong

+852 3963 8411

SALES | LETTINGS | PROPERTY MANAGEMENT | PROPERTY INVESTMENTS

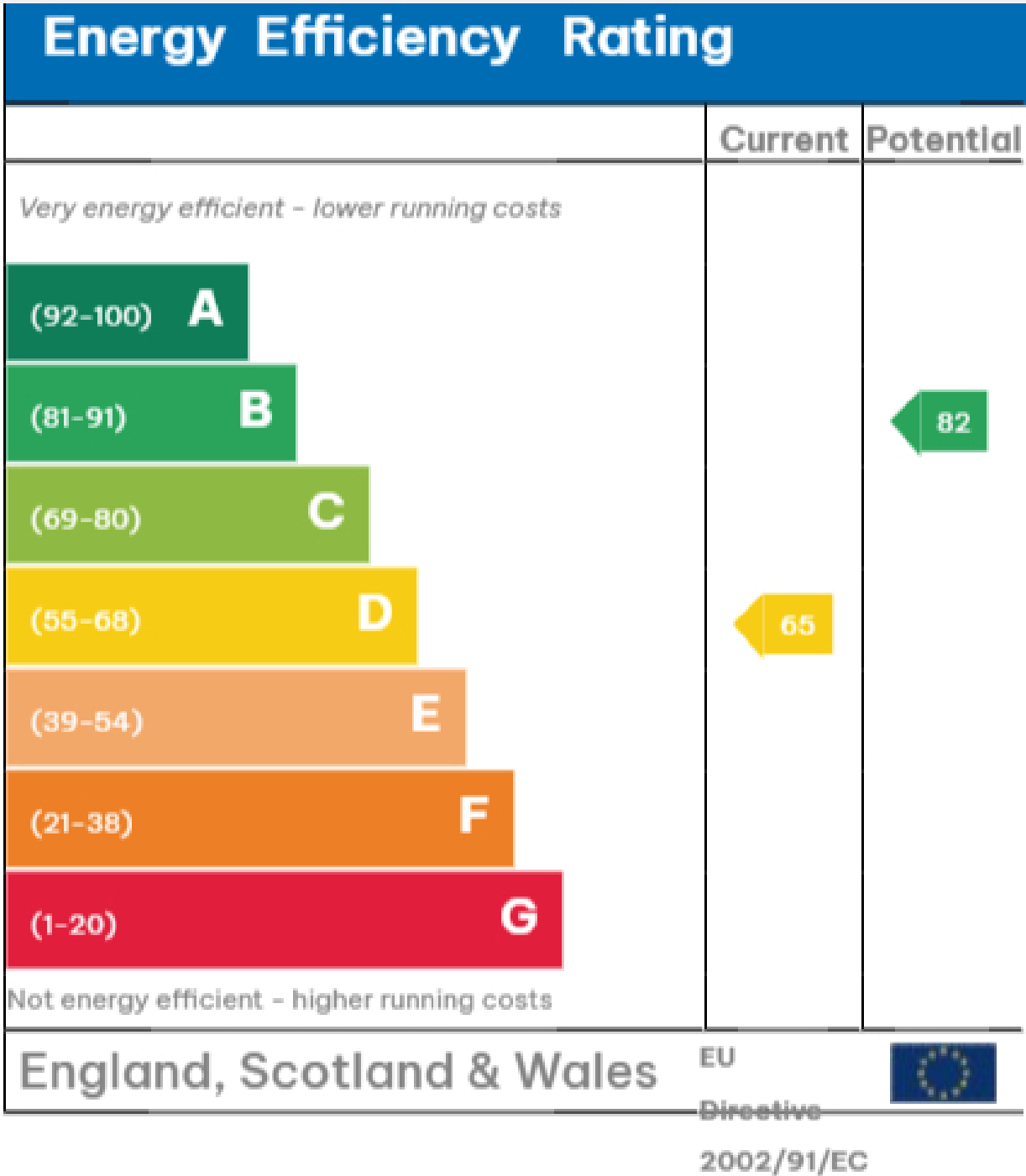



GLOBAL  
HOUSE  
ESTATES

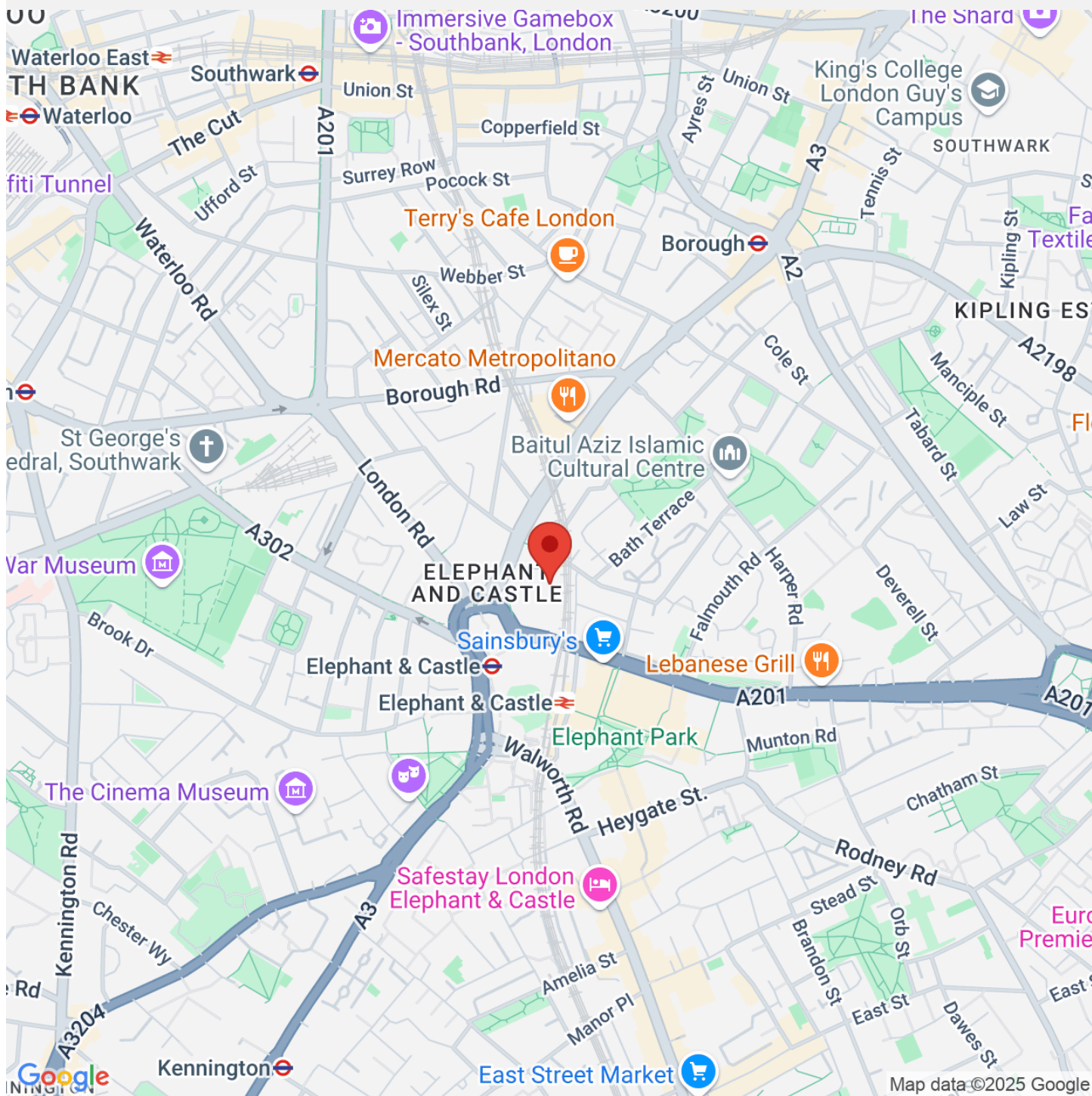

35a St Georges Road,  
London SE1 6EW  
+44 (0) 207 401 2020

[www.globalhouseestates.com](http://www.globalhouseestates.com)

Level 24, Lee Garden One,  
33 Hysan Ave, Causeway  
Bay, Hong Kong  
+852 3963 8411

SALES | LETTINGS | PROPERTY MANAGEMENT | PROPERTY INVESTMENTS