

**Asking Price Of £375,000.00**  
**Vincent Court, Stockwell, London SW9 0QU**



## PROPERTY OVERVIEW

**1 Bedroom   1 Bathroom   1 Reception**

Nestled in a quiet area between Kennington and Stockwell, in a greatly maintained block, this one bedroom flat offers a tranquil retreat from the city life.

Upon entering, you are greeted by the bright hallway leading you into the apartment. The spacious living and dining area seamlessly connects to the kitchen, equipped with integrated appliances. The apartment's windows perfectly capture the natural light throughout the day.

Storage options abound, from the hallway cupboard to the built-in storage in the large double bedroom, and more available in the attic. The property features a three-piece bathroom and double-glazed windows throughout which enhance energy efficiency, ensuring a comfortable environment year-round.

Off street parking is also included for residents as well as acces ...

35a St Georges Road,  
London SE1 6EW

+44 (0) 207 401 2020

[www.globalhouseestates.com](http://www.globalhouseestates.com)

Level 24, Lee Garden One,  
33 Hysan Ave, Causeway  
Bay, Hong Kong

+852 3963 8411

SALES | LETTINGS | PROPERTY MANAGEMENT | PROPERTY INVESTMENTS



35a St Georges Road,  
London SE1 6EW  
+44 (0) 207 401 2020

[www.globalhouseestates.com](http://www.globalhouseestates.com)

Level 24, Lee Garden One,  
33 Hysan Ave, Causeway  
Bay, Hong Kong  
+852 3963 8411

SALES | LETTINGS | PROPERTY MANAGEMENT | PROPERTY INVESTMENTS





35a St Georges Road,  
London SE1 6EW  
+44 (0) 207 401 2020

[www.globalhouseestates.com](http://www.globalhouseestates.com)

Level 24, Lee Garden One,  
33 Hysan Ave, Causeway  
Bay, Hong Kong  
+852 3963 8411

SALES | LETTINGS | PROPERTY MANAGEMENT | PROPERTY INVESTMENTS



GLOBAL  
HOUSE  
ESTATES



35a St Georges Road,  
London SE1 6EW  
+44 (0) 207 401 2020

[www.globalhouseestates.com](http://www.globalhouseestates.com)

Level 24, Lee Garden One,  
33 Hysan Ave, Causeway  
Bay, Hong Kong  
+852 3963 8411

SALES | LETTINGS | PROPERTY MANAGEMENT | PROPERTY INVESTMENTS

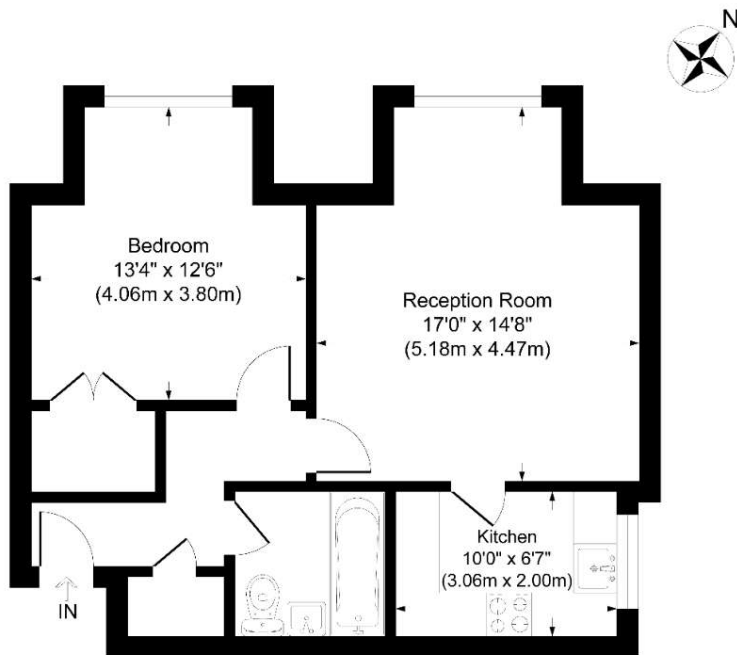

Third Floor

Vincent Court 96  
Hackford Road

Approximate Gross Internal Area  
Total = 54.6 sq m / 588 sq ft

This plan is for layout guidance only. Not drawn to scale unless stated.  
Windows and door openings are approximate. Whilst every care is taken  
in the preparation of this plan, please check all dimensions, shapes and  
compass bearings before making any decisions reliant upon them.

powered by:  
**THE360IMAGE**  
www.the360image.co.uk

35a St Georges Road,  
London SE1 6EW  
+44 (0) 207 401 2020

[www.globalhouseestates.com](http://www.globalhouseestates.com)

Level 24, Lee Garden One,  
33 Hysan Ave, Causeway  
Bay, Hong Kong  
+852 3963 8411

SALES | LETTINGS | PROPERTY MANAGEMENT | PROPERTY INVESTMENTS





GLOBAL  
HOUSE  
ESTATES

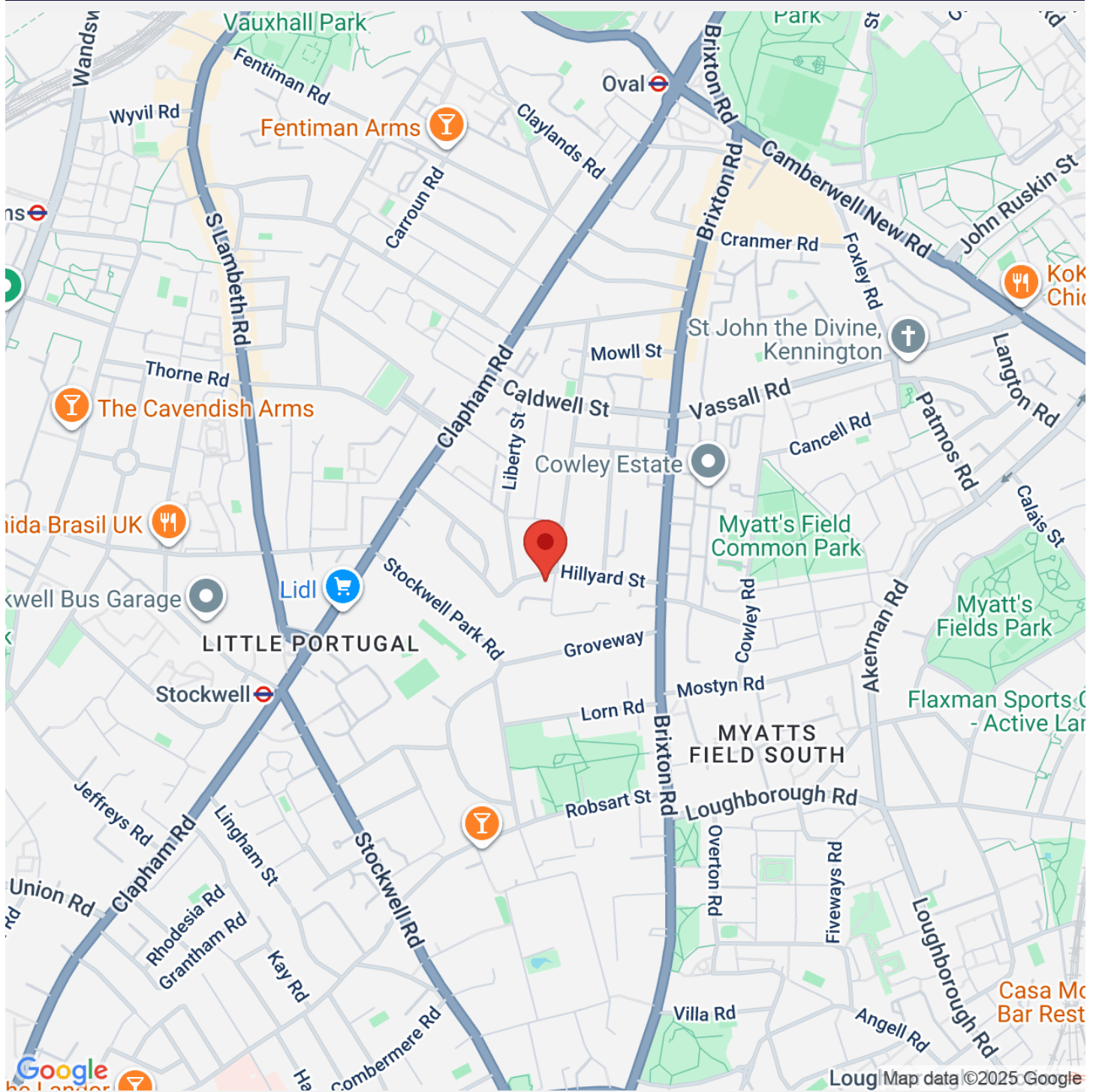

35a St Georges Road,  
London SE1 6EW  
+44 (0) 207 401 2020

[www.globalhouseestates.com](http://www.globalhouseestates.com)

Level 24, Lee Garden One,  
33 Hysan Ave, Causeway  
Bay, Hong Kong  
+852 3963 8411

SALES | LETTINGS | PROPERTY MANAGEMENT | PROPERTY INVESTMENTS