

0247 401 2020 | enquiries@globalhousestates.com

CASCADES TOWER, CANARY WHARF, LONDON

£2,500.00



FOR LET



- Two Bedroom Apartment
- Two Bathroom (en-suite)
- Stunning River Views
- 24 Hour Concierge
- Swimming Pool & Gym
- Heating included In Rent
- Secure Parking

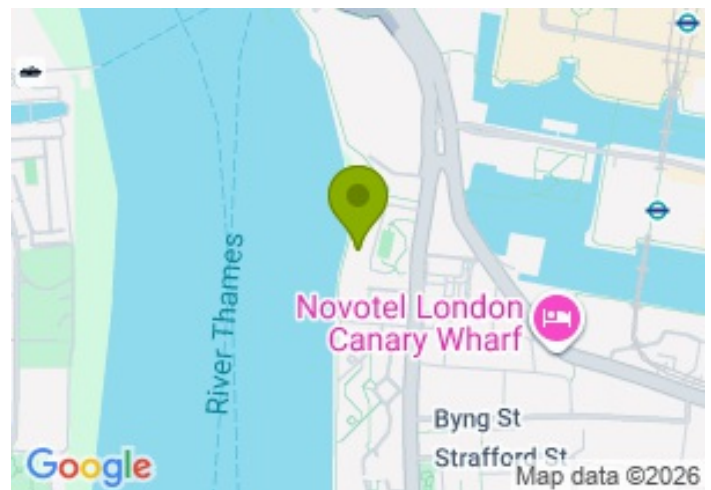

Property Description

This impressive two bedroom apartment located on the 14th floor with stunning Canary Wharf views and within a short walk from the bustling Canary Wharf, situated in the Cascades Tower development. The property benefits from an abundance of light and offers a private balcony. There is an open plan kitchen which incorporates integrated appliances and a sizeable reception room leading to a private balcony with far reaching views. The master bedroom offers a walk in wardrobe along with access to a smart en suite bathroom, whilst the second bedroom also offers built in storage. There is one secure parking space along with a 24 hour concierge, a residents' gym and swimming pool.

Cascades Tower is the closest residential development on Westferry Road to Canary Wharf (0.4 miles). Transport links can be found at Canary Wharf Jubilee Line (0.4 miles) and Heron Quays DLR (0.3 miles). All times and distances are approximate.

Viewing

Please contact our Global House Estates Ltd Office on 0207 401 2020 if you wish to arrange a viewing appointment for this property or require further information.

Disclaimer

This website provides information about buying, selling, renting UK property. The information is from reliable sources, but we can't guarantee that it's always accurate. There may be mistakes or changes in the information, such as price, availability, leases, or financing. The square footage is also an estimate and should be confirmed by a professional architect or engineer.

Floor plan

Cascade Towers, E14

Total Area: 72.9 m² ... 785 ft² (excluding balcony)

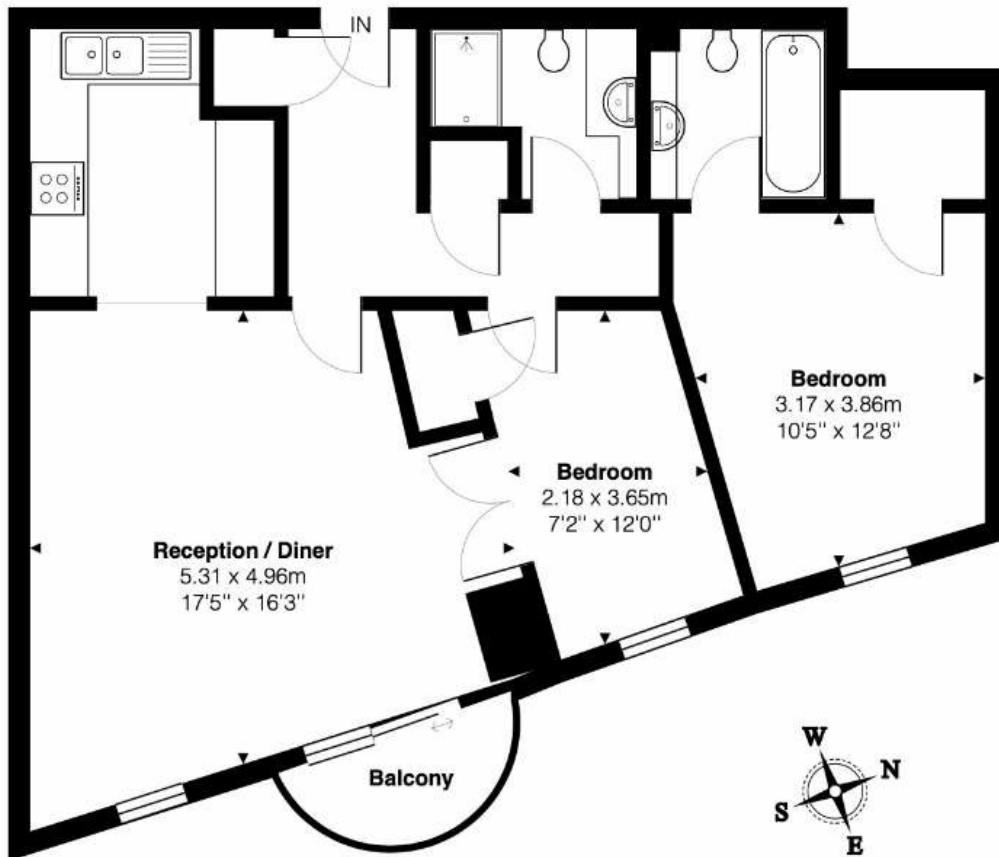

14th Floor

This Floor plan is provided without warranty, of any kind.
Bespoke Plans disclaims any warranty including,
without limitation, satisfaction, quality or accuracy of any dimensions

EPC

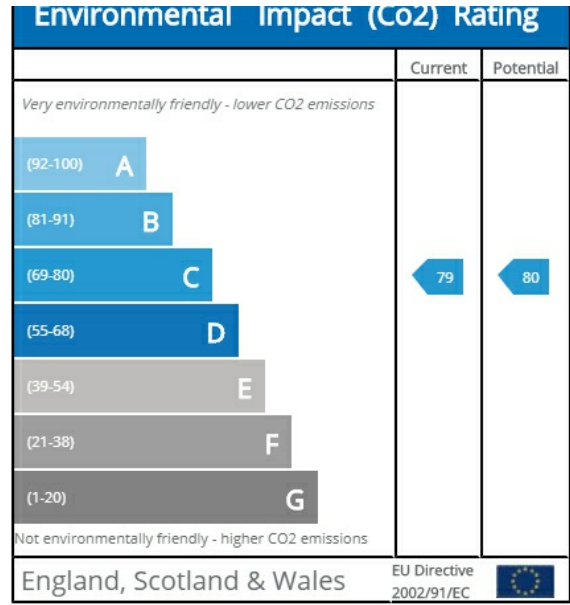
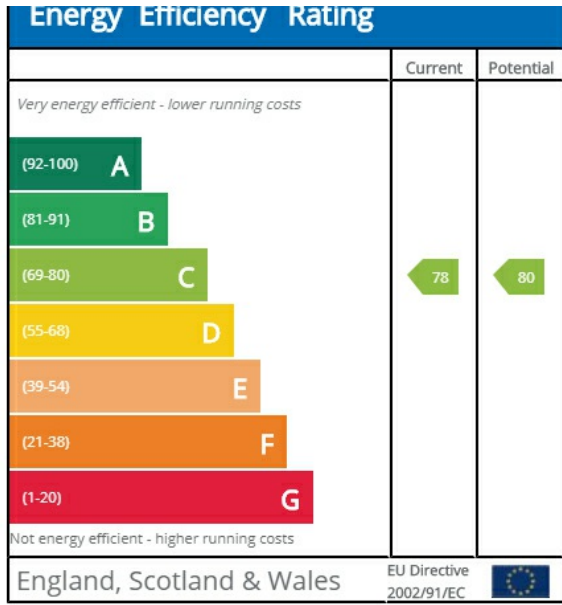





35a St Georges Road, London,
SE1 6EW
+44 (0) 207 401 2020

<https://globalhousestates.com>

Level 24, Lee Garden One,
33 Hysan Ave, Causeway Bay,
Hong Kong
+852 3963 8411