

0247 401 2020 | enquiries@globalhouseestates.com

MALTINGS PLACE, FULHAM, LONDON

£450,000.00



FOR SALE



- Modern 1 bedroom top floor apartment
- Private Gated Development
- Off Street Parking Space
- Long Lease
- No onward chain
- Communal Gardens
- Natural light throughout
- Prime location

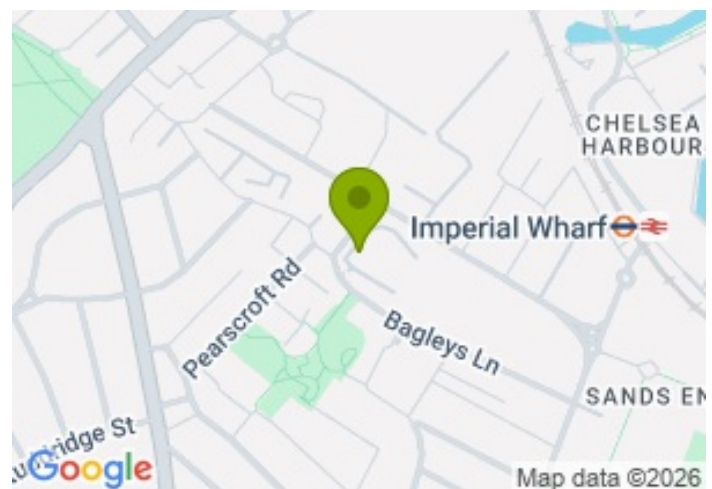

Property Description

We're thrilled to introduce this charming one-bedroom flat in the heart of Fulham, set in Maltings Place, just moments away from Fulham Broadway and the River Thames. Located within a gated development, this property offers a bright and airy open-plan living space, blending style with practicality.

As you step inside, you are greeted by a welcoming living room that flows effortlessly into a well-designed kitchen. This is perfect for both cosy evenings in and hosting friends. The space is bathed in natural light, creating an inviting atmosphere.

The bedroom is a serene sanctuary, featuring a built-in sliding double-door wardrobe with a sleek, handle-less design and subtle lighting, offering ample storage without compromising on style. The bathroom is a modern retreat, complete with a deep bathtub with an integrated shower, a stylish vanity unit with integrated storage, and premium fixtures that elevate the space.

Just outside, a communal green area provides a peaceful spot to relax or enjoy a moment of calm. For added convenience, there is dedicated and secure car parking available at the front of the building for you or your guests.

Featuring contemporary finishes and a neutral palette, this home is designed for effortless living in one of London's most sought-after gated communities. Whether you are looking for a peaceful retreat or a stylish pied-à-terre, this Fulham gem is ready to welcome you home.

Residents are within easy reach of Imperial Wharf station, West Brompton and Wandsworth station, providing convenient connections into Central London and beyond.

Service charge: Circa £4096 per annum

Ground rent: 100 per annum

Length of lease: 957 year remaining

All data and information set forth on this website regarding real property, for sale, purchase, rental and/or financing, are from sources regarded as reliable. No warranties are made as to the accuracy of any descriptions and/or other details and such information is subject to errors, omissions, changes of price, tenancies, commissions, prior sales, leases or financing, or withdrawal without notice. Square footages are approximate and may be verified by consulting a professional architect or engineer.

Viewing

Please contact our Global House Estates Ltd Office on 0207 401 2020 if you wish to arrange a viewing appointment for this property or require further information.

Disclaimer

This website provides information about buying, selling, renting UK property. The information is from reliable sources, but we can't guarantee that it's always accurate. There may be mistakes or changes in the information, such as price, availability, leases, or financing. The square footage is also an estimate and should be confirmed by a professional architect or engineer.

Floor plan

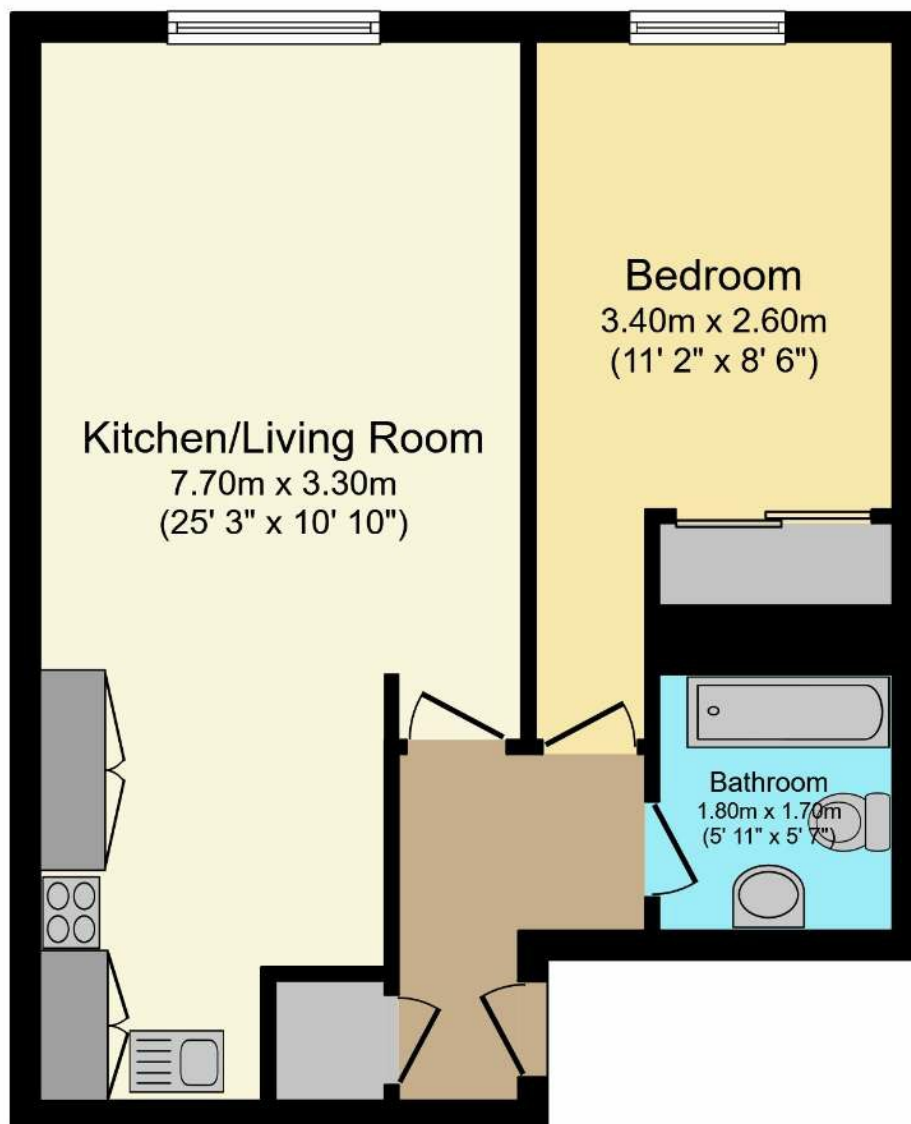

Total floor area 44.4 sq.m. (478 sq.ft.) approx

This plan is for illustration purposes only and may not be representative of the property. Plan not to scale. Powered by [audioagent.com](https://www.audioagent.com)







35a St Georges Road, London,
SE1 6EW
+44 (0) 207 401 2020

<https://globalhouseestates.com>

Level 24, Lee Garden One,
33 Hysan Ave, Causeway Bay,
Hong Kong
+852 3963 8411