

0247 401 2020 | enquiries@globalhousestates.com

JQ RISE, 1 GOODMAN STREET, BIRMINGHAM, UK

£950.00



FOR LET



- Furnished or unfurnished, landlord is flexible.
- Located on 1/F with private balcony
- Located in B1, Jewellery Quarter and close to Birmingham city centre
- Available 1Aug26

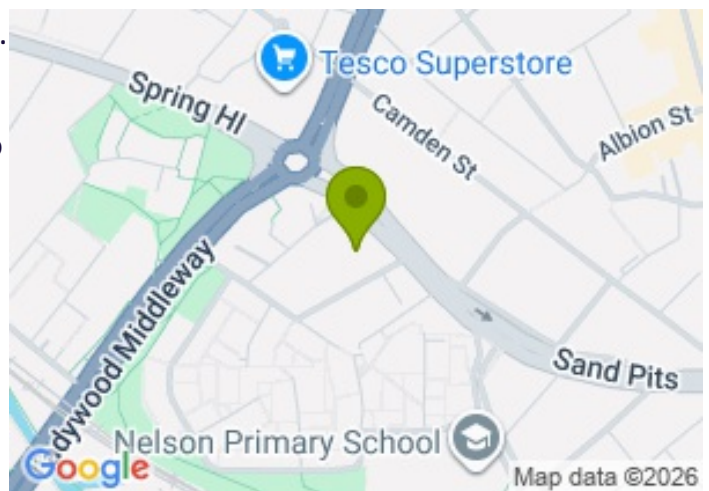

## Property Description

Gateway to the Jewellery Quarter, JQ Rise is a striking landmark tower offering extraordinary views and unrivalled city centre access. This property provides a stunning and spacious one bedroom modern luxury apartment on the 1st floor.

JQ Rise is located just ten minutes walk to the business and financial districts of Brindley Place, Arena Central and Colmore Row. The luxury apartment features a high quality interior specification and configuration, specifically designed to cater to the rising young professional rental demand of the city centre.

The property comprises of open plan living and dining areas. The kitchen is fully integrated with dishwasher, fridge freezer, oven, hob and extractor.

The double bedroom is spacious. The main bathroom benefits from a bath and alongside matching appliances. There is also a separate utility room which houses the washing machine.

This apartment is just a short walk from Birmingham city centre, making it an ideal choice for those seeking a blend of comfort and convenience in a prime location.

## Viewing

Please contact our Global House Estates Ltd Office on 0207 401 2020 if you wish to arrange a viewing appointment for this property or require further information.

## Disclaimer

This website provides information about buying, selling, renting UK property. The information is from reliable sources, but we can't guarantee that it's always accurate. There may be mistakes or changes in the information, such as price, availability, leases, or financing. The square footage is also an estimate and should be confirmed by a professional architect or engineer.

# Floor plan

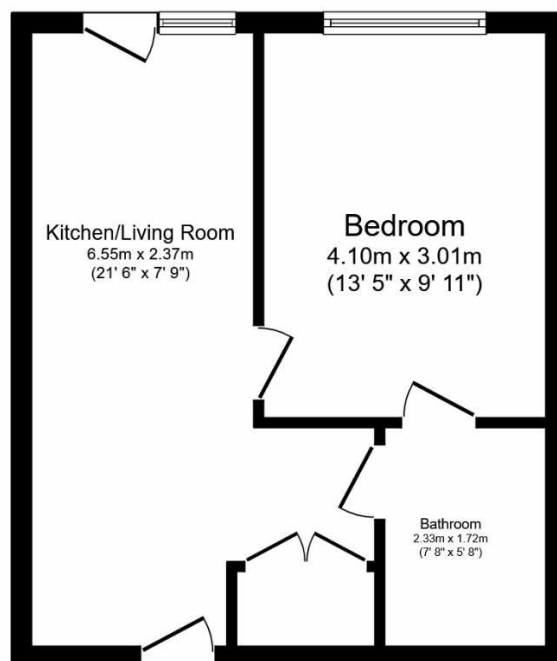

Total floor area 35.8 m<sup>2</sup> (385 sq.ft.) approx

This floor plan is for illustrative purposes only. It is not drawn to scale. Any measurements, floor areas (including any total floor area), openings and orientation are approximate. No details are guaranteed, they cannot be relied upon for any purpose and they do not form part of any agreement. No liability is taken for any error, omission or misstatement. A party must rely upon its own inspection(s).  
Powered by [www.focalagent.com](http://www.focalagent.com)

# EPC

