

0247 401 2020 | [enquiries@globalhouseestates.com](mailto:enquiries@globalhouseestates.com)

## MALTINGS PLACE, TOWER BRIDGE, LONDON

£399,000.00



FOR SALE



- Grade II listed Building
- Gated Development
- Fantastic Location
- Studio Apartment
- Chain Free
- Short Walk to Bermondsey Street & Tower Bridge
- Great views of The Shard and city skyline
- Concierge & communal courtyard with seating area

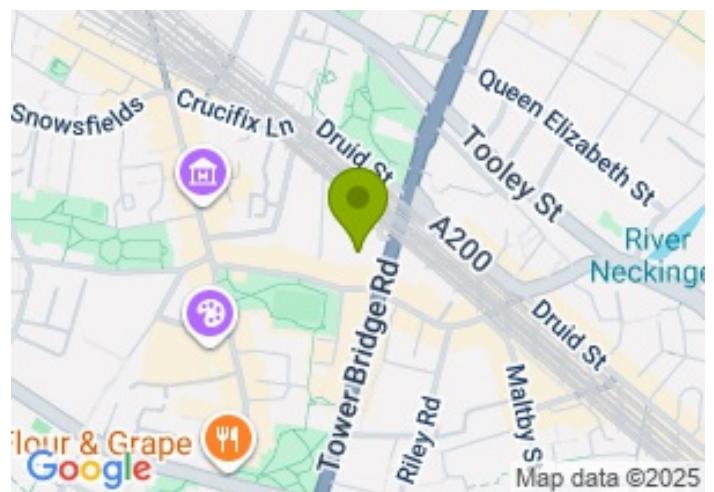

## Property Description

This beautifully presented studio apartment is set on the third floor of Malting's Place – a unique, gated warehouse conversion within the historic Sarson's Vinegar Factory. Offering a well-designed living space, this bright and inviting home perfectly blends industrial charm with modern comfort, all in a highly sought-after central location.

As you step inside, you're welcomed by high ceilings, elegant wood flooring, and abundant natural light streaming through the floor-to-ceiling windows.

The separate kitchen is fully fitted with integrated appliances, offering practical functionality without compromising on style.

The living space has been intelligently arranged to function seamlessly as both a relaxing lounge and a restful sleeping area, offering views towards The Shard and the city skyline. The apartment also benefits from underfloor heating and double-glazed windows for good energy efficiency.

Residents benefit from 24-hour concierge, lift access and a beautifully landscaped communal courtyard with seating areas.

Malting's Place enjoys an exceptional location just moments from the lively Bermondsey Street and the riverside charm of Shad Thames, renowned for their artisan cafés, acclaimed restaurants, and boutique shops. Culture enthusiasts will enjoy being a short walk from the White Cube Gallery and other local arts venues. Green spaces like Tanner Street Park and Leathermarket Gardens are also nearby.

Commuting is simple with both London Bridge and Bermondsey stations within easy reach, offering swift access to the City, Canary Wharf, and the West End.

Offered with no onward chain, this stunning studio apartment could be an ideal first home or investment opportunity. Contact us today to arrange your viewing.

Service charge: circa £2780 per annum (including water )

Ground rent: £500 per annum

Lease: 114 years remaining

All data and information set forth on this website regarding real property, for sale, purchase, rental and/or financing, are from sources regarded as reliable. No warranties are made as to the accuracy of any descriptions and/or other details and such information is subject to errors, omissions, changes of price, tenancies, commissions, prior sales, leases or financing, or withdrawal without notice. Square footages are approximate and may be verified by consulting a professional architect or engineer.

## Viewing

Please contact our Global House Estates Ltd Office on 0207 401 2020 if you wish to arrange a viewing appointment for this property or require further information.

# Disclaimer

This website provides information about buying, selling, renting UK property. The information is from reliable sources, but we can't guarantee that it's always accurate. There may be mistakes or changes in the information, such as price, availability, leases, or financing. The square footage is also an estimate and should be confirmed by a professional architect or engineer.

# Floor plan

## Tower Bridge Road, SE1 3JB

Approx Gross Internal Area = 32.3 sq m / 348 sq ft

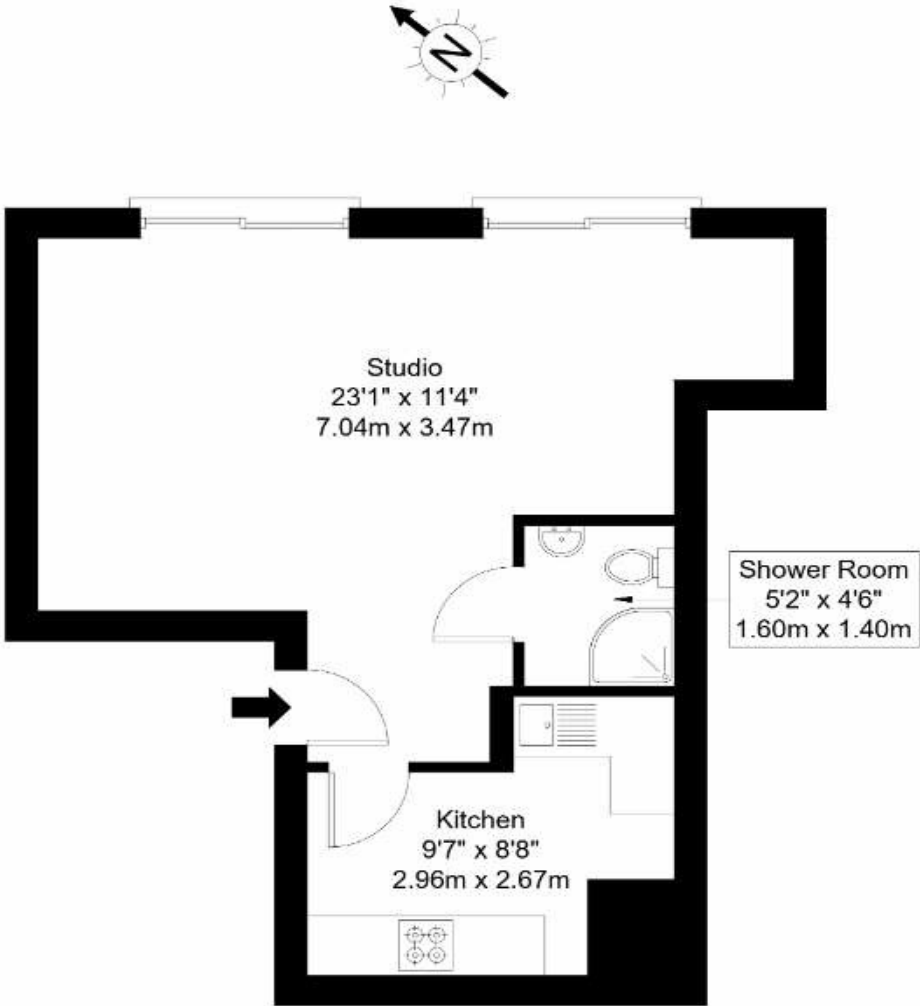

Third Floor

Ref :

Copyright **BLEU  
PLAN**

The Floor plan is not to scale and measurements and areas shown are approximate and therefore should be used for illustrative purposes only. The plan has been prepared in accordance with the RICS code of Measuring Practice and whilst we have confidence in the information produced it must not be relied on. Maximum lengths and widths are represented on the floor plan. If there is any aspect of particular importance, you should carry out or commission your own inspection of the property.  
Copyright @ BleuPlan

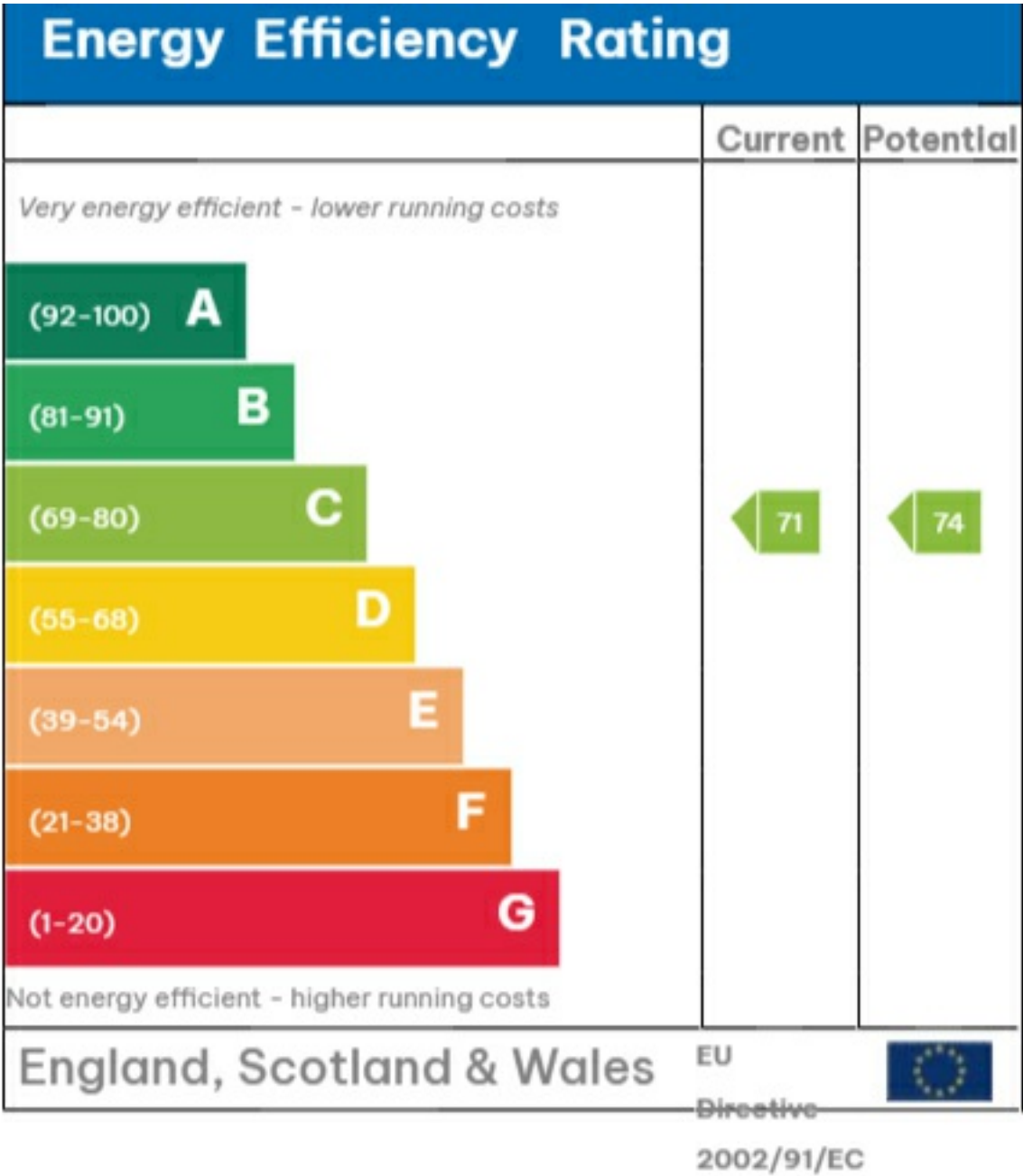







35a St Georges Road, London,  
SE1 6EW  
+44 (0) 207 401 2020

<https://globalhouseestates.com>

Level 24, Lee Garden One,  
33 Hysan Ave, Causeway Bay,  
Hong Kong  
+852 3963 8411