

0247 401 2020 | enquiries@globalhouseestates.com

CASCADES TOWER, CANARY WHARF, LONDON

£600.00



FOR LET



- Two Bedroom Apartment
- Gymnasium & Swimming Pool
- 24h Concierge Service
- Stunning Views & Private Balcony
- Next to Canary Wharf
- Close To Amenities
- Heating included in the rent

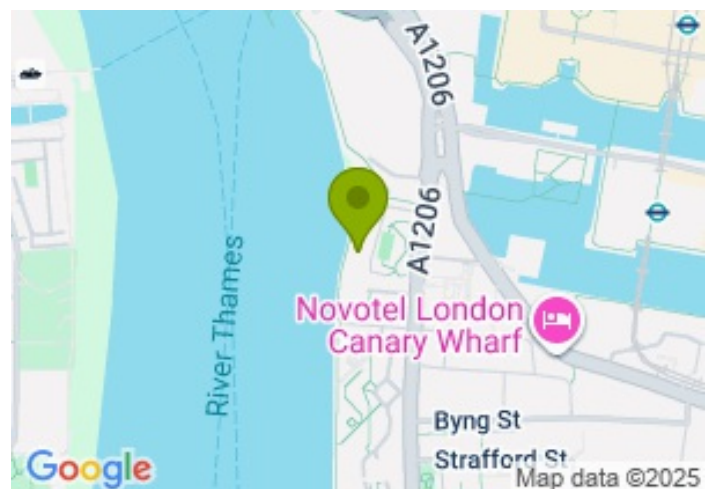

Property Description

Located next to the Thames is this superb two bedroom apartment that has a modern and light interior with a high-specification finish. Set up high on the 13th floor of a desirable development, the property comprises generous reception room with balcony access, modern fitted and fully integrated kitchen, generous master bedroom with sumptuous en-suite bathroom, second double bedroom and bathroom. The property benefits from balcony that enjoy views of the Canary Wharf Tower, concierge service, gymnasium, swimming Pool and Tennis court.

Viewing

Please contact our Global House Estates Ltd Office on 0207 401 2020 if you wish to arrange a viewing appointment for this property or require further information.

Disclaimer

This website provides information about buying, selling, renting UK property. The information is from reliable sources, but we can't guarantee that it's always accurate. There may be mistakes or changes in the information, such as price, availability, leases, or financing. The square footage is also an estimate and should be confirmed by a professional architect or engineer.

Floor plan

Cascade Towers, E14

Approximate Gross Internal Area = 70.9 sq m / 763 sq ft

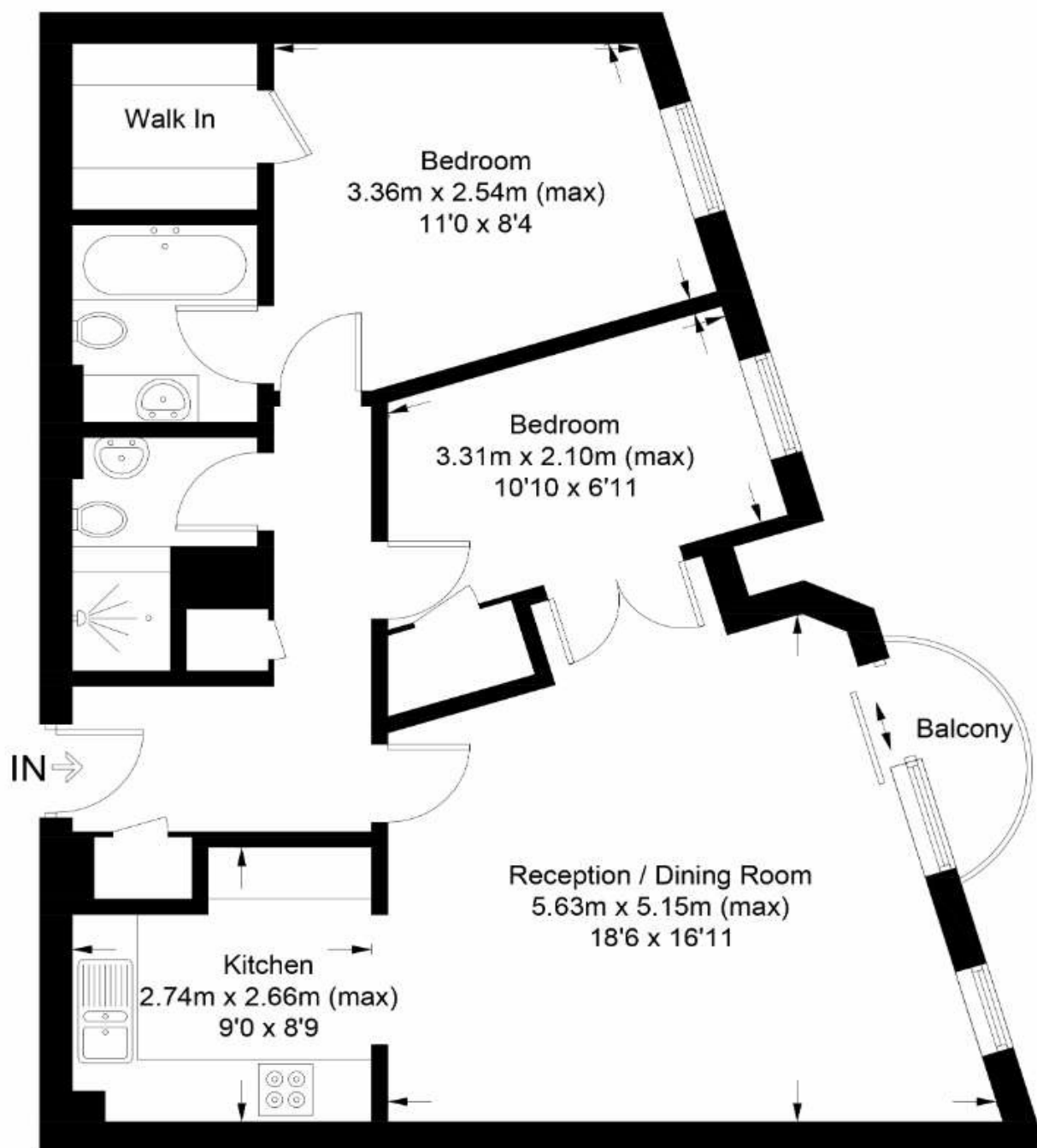

Thirteenth Floor

This floor plan is for representation purposes only and is not drawn to scale.

The Gross Internal Area includes outbuildings shown on the plan.

Whilst every attempt has been made to ensure the accuracy of the plan measurements of doors, windows and rooms are approximate only and should be checked before making any decisions reliant upon them.

Copyright Bespokeplans.co.uk (ID770497)

EPC

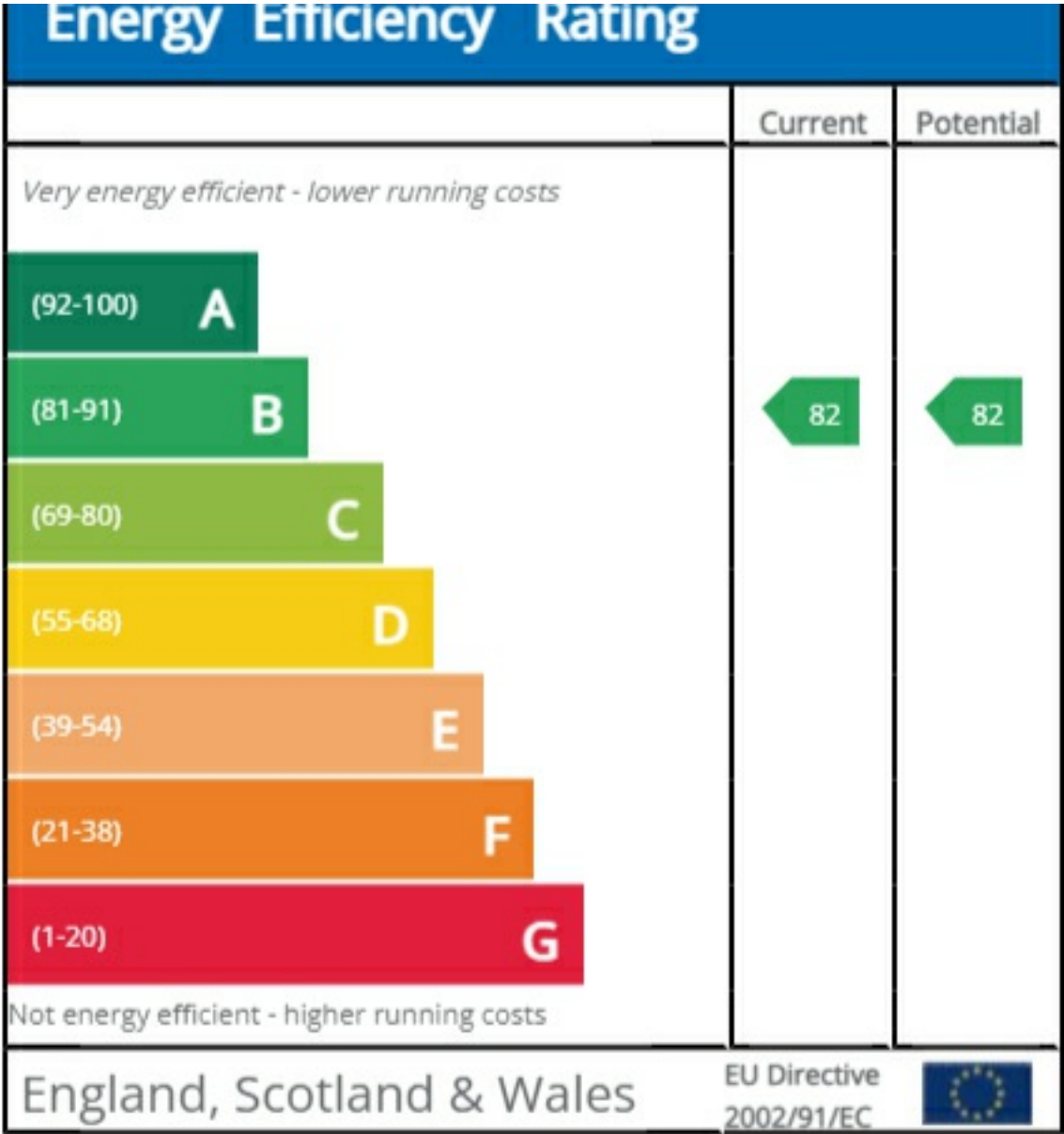





35a St Georges Road, London,
SE1 6EW
+44 (0) 207 401 2020

<https://globalhouseestates.com>

Level 24, Lee Garden One,
33 Hysan Ave, Causeway Bay,
Hong Kong
+852 3963 8411